

Stopper
Stopper
Butée
Fermo
Tope
Limitador

3 842 555 617/2016-02

Replaces: –
DE+EN+FR+IT+ES+PT



Montageanleitung • Assembly instructions • Instructions de montage
Istruzioni per il montaggio • Instrucciones de montaje • Instruções de montagem

3 842 552 151

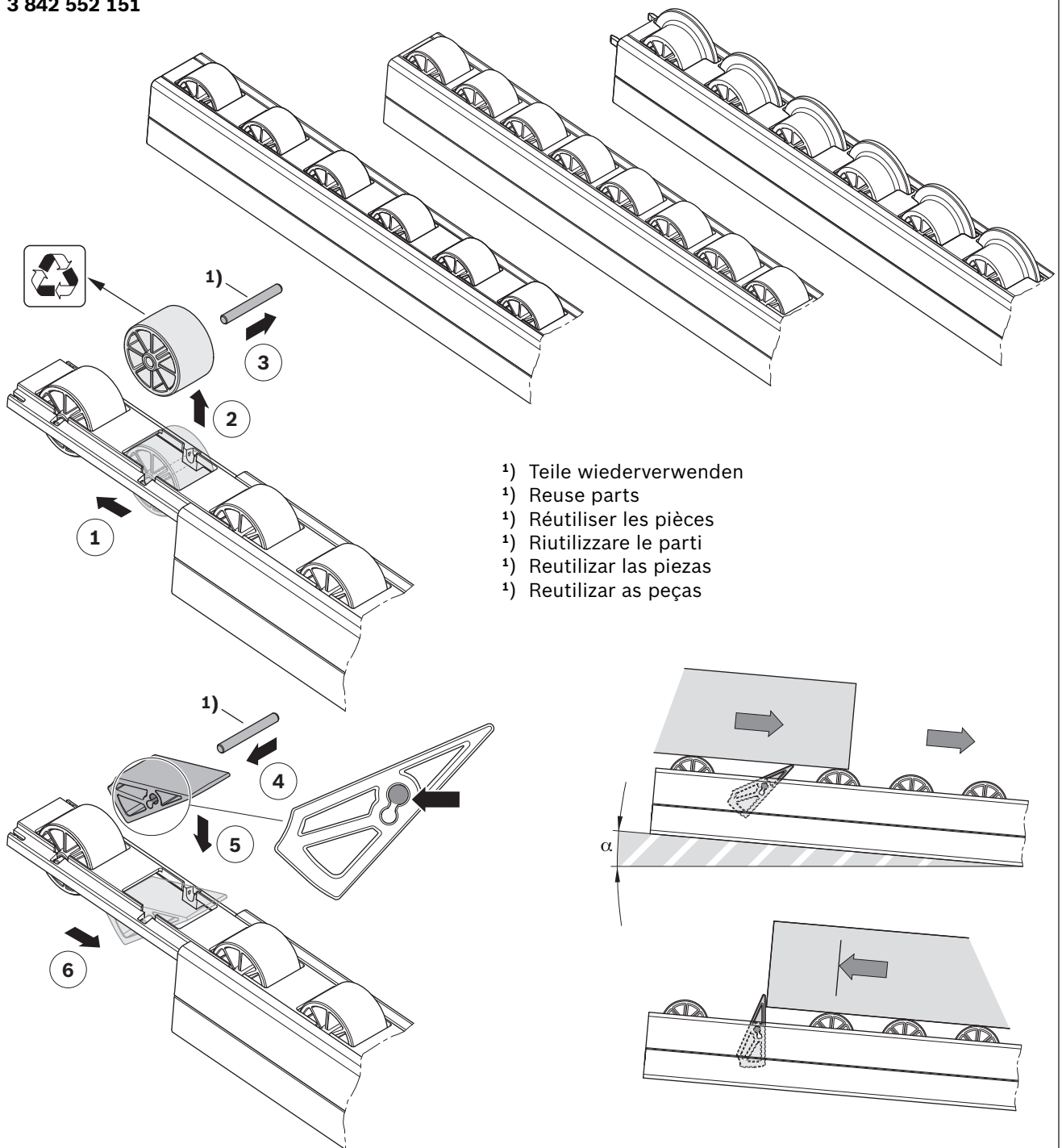

- 1) Teile wiederverwenden
- 1) Reuse parts
- 1) Réutiliser les pièces
- 1) Riutilizzare le parti
- 1) Reutilizar las piezas
- 1) Reutilizar as peças

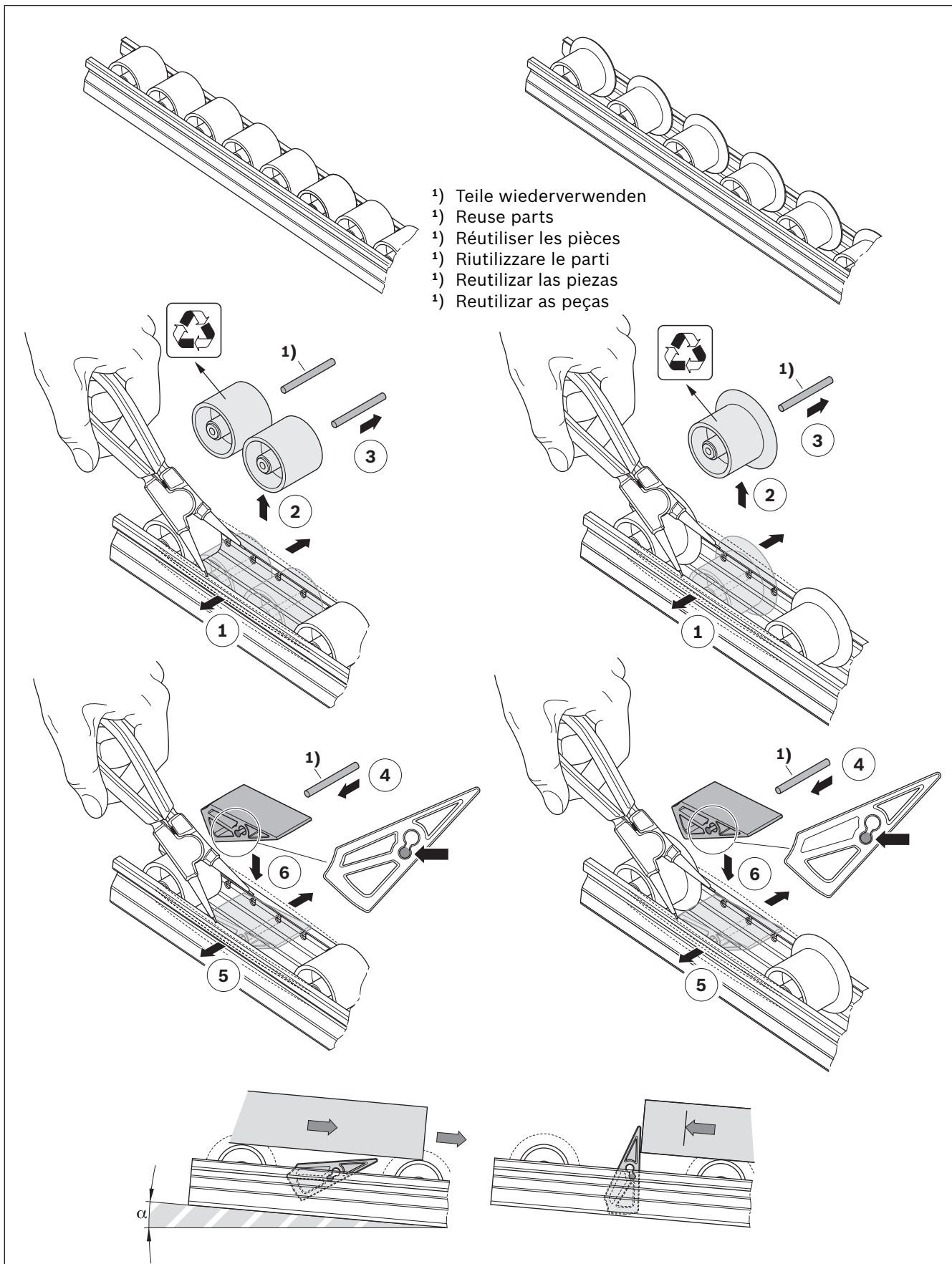

358 717-02